

# GROUND FLOOR

### Electronic door lock

- a) The lock shall release upon actuation of the fire alarm system.
- b) The lock shall fail safe to open i.e. unlock on loss of power supply or disconnection of any relevant cable.
- c) An emergency "break glass" override switch, coloured green is sited adjacent to each door marked SL with instructions to open.

\*SL - As indicated on Key to Plan Symbols.

Approx Scale: 1:200

Amend No:

Amend Date:

Acad Dwg Name: 01-11517-B-G

Sheet Size: A3



Denotes upward direction of staircase.

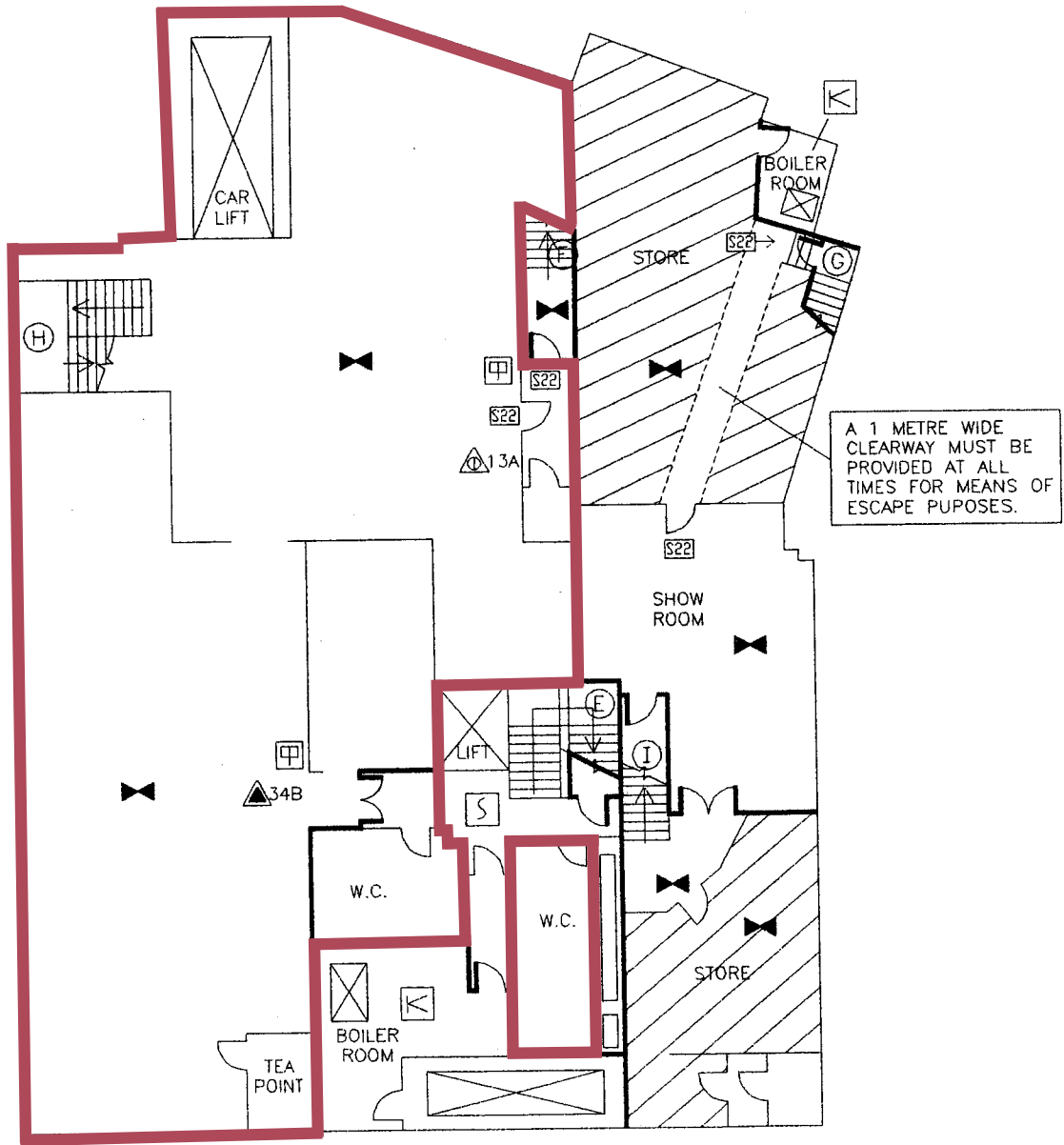

GRO1

BASEMENT



**L F C D A**  
LONDON FIRE BRIGADE

File Ref: FS/WN/01/11517  
Address: 22 & 23/25 EASTCASTLE STREET  
LONDON  
W1

Plan No: 1 OF 3  
Drawn By: J.C.  
Date: 23-3-00  
Update: 03-04-00 J